

DR系列 弹性联轴器
DB series flexible coupling

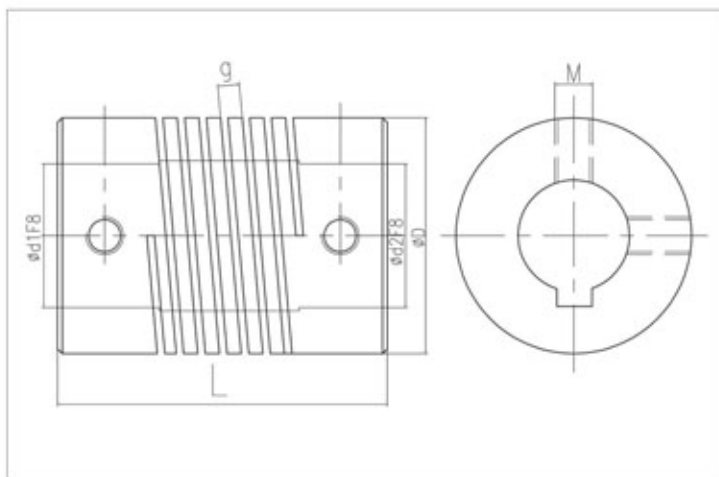

DR系列微型狭缝弹性联轴器特点

Features of DR series mini slot flexible coupling

DR系列微型狭缝弹性联轴器，适用于较小扭矩的轴联接，采用紧固螺栓的方式来使轴心固定，这是一种最传统、成本最低的固定方式。但是，螺栓的前端与轴心直接接触可能会造成轴心的损伤或拆卸困难。

DR series mini slot flexible coupling can be used for little torque and shaft-joint. Tighten the slot with screw to hold the shaft. This is a low-cost assemble method. However, the points setscrews may cause damage to the shaft and may be difficult to remove

一体成型的金属弹性联轴器其弹性作用可补偿角向和轴向偏差，零回间隙、免维护，抗油和耐腐蚀性，两端不同大小的产品也备有库存，您可根据您的需要来选择所需产品！

One-piece metallic flexible coupling can absorb parallel, angle and end-play misalignments, zero backlash, no maintenance needed, Resistant to oil and cauterization. Stock for different bore size on 2 sides available. Specification on request.

DR系列主体材料为：铝合金（特殊孔径和键槽均可按需求加工）

Body material: Aluminum alloy(Special bore size and slot available on request)

项目类型 Item type	d1 Bore	d2 Bore	D	L	g	M	额定扭矩 Rated Torque (N.m)	最大扭矩 Max. Torque	偏心误差 eccentricity error	轴角偏角 Shaft angel	最高转速 Max. Rotational (rpm)	运转 Rated
DR	4-18	4-8	15	20-30	2.5	M2.5-3	1N.m	2N.m	±0.2mm	≤2°	1900	同步运转 In-phase operate
	4-10	4-10	18	20-35	2.5	M2.5-4	1N.m	2N.m	±0.2mm	≤2°	1900	
	4-12	4-12	20	25-35	2.5	M3-4	1N.m	2N.m	±0.2mm	≤2°	1900	
	4-15	4-15	25	25-40	2.5	M3-4	1.5N.m	3N.m	±0.2mm	≤2°	1900	
	5-18	5-18	30	30-45	2.5	M4-6	1.5N.m	3N.m	±0.2mm	≤2°	1900	
	5-20	5-20	35	30-45	2.5	M4-6	2N.m	4N.m	±0.2mm	≤2°	1900	

可根据客户要求加工定制

Can be produced on client's request

(定货范例 ordering example) DR-15×15-D30L45

(用户端孔径 bore size on user's end) d1

(用户端孔径 bore size on user's end) d2

(联轴器总长 total length of the coupling) L

(联轴器最大外径 Max. housing diameter of coupling) D

DR适用 For DR series

改变项 (Alternative item)	代号 Code name	指定 Appointment	元/批 RMB/batch
	d1, d2	客户需要的孔径 bore size on client's request	另行报价 special quote